

Metric Class 10.9 JIS Hex Flange Screws

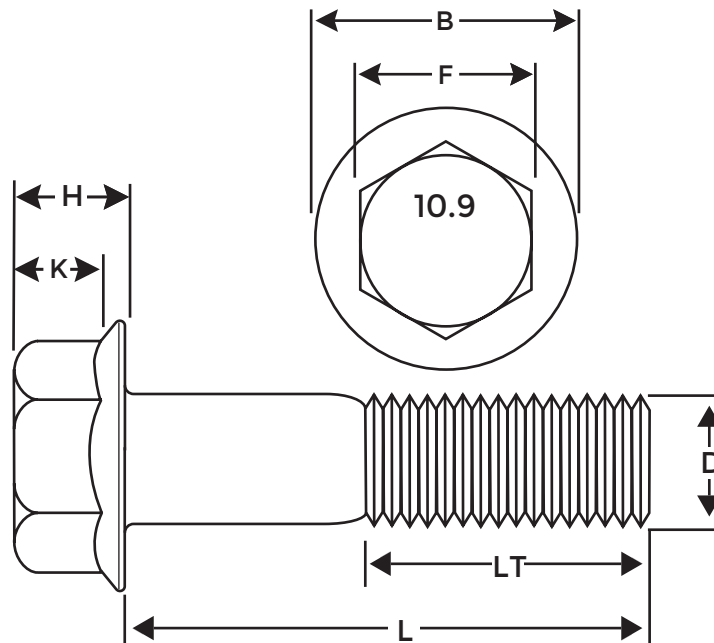

Millimeters							
Nominal Size or Basic Bolt Diameter	F		H	B	K	D	
	Width Across Flats		Height of Head	Flange Dia.	Wrench Height	Full Size Body Diameter	
	Max	Min	Max	Max	Min	Max	Min
M6-1.0	10.00	9.80	6.00	14.00	3.60	6.00	5.90
M8-1.25	12.00	11.75	8.00	17.50	4.80	8.00	7.85
M10-1.25	14.00	13.75	10.00	21.00	6.00	10.00	9.85
M12-1.25	17.00	16.75	11.50	25.00	7.20	12.00	11.80
Dimensions: Small Head - JIS B1189 Type 2 Material: Class 10.9 Tensile Strength: 1040N/MM2 Minimum							

Thread Length Chart			
DIA.	FULL THREAD LENGTH	PARTIAL THREAD LENGTH	PARTIAL THREAD THREAD LENGTH
M6	THROUGH 25mm	26mm & LONGER	Min 18-21mm
M8	THROUGH 30mm	31mm & LONGER	Min 22-25mm
M10	THROUGH 35mm	36mm & LONGER	Min 26-29mm
M12	THROUGH 35mm	36mm & LONGER	Min 30-33mm

+86-755-27904883

flangebolts.cn

flange.bolts@made-parts.com

ONLINE FASTENER GROUP LLC CLAIMS ALL PROPRIETARY RIGHTS TO THIS DRAWING AND THE INFORMATION IT CONTAINS. THIS MATERIAL IS CONFIDENTIAL. DISCLOSURE, REPRODUCTION, AND MANUFACTURING IS STRICTLY PROHIBITED WITHOUT THE EXPRESS WRITTEN PERMISSION OF ONLINE FASTENER GROUP LLC . ALL RIGHTS OF DESIGN OR INVENTION ARE RESERVED.